

This document contains proprietary information and may not be reproduced or copied without the express written permission of a duly authorized representative of MPD.

REV	DESCRIPTION	DSG	APR	DATE

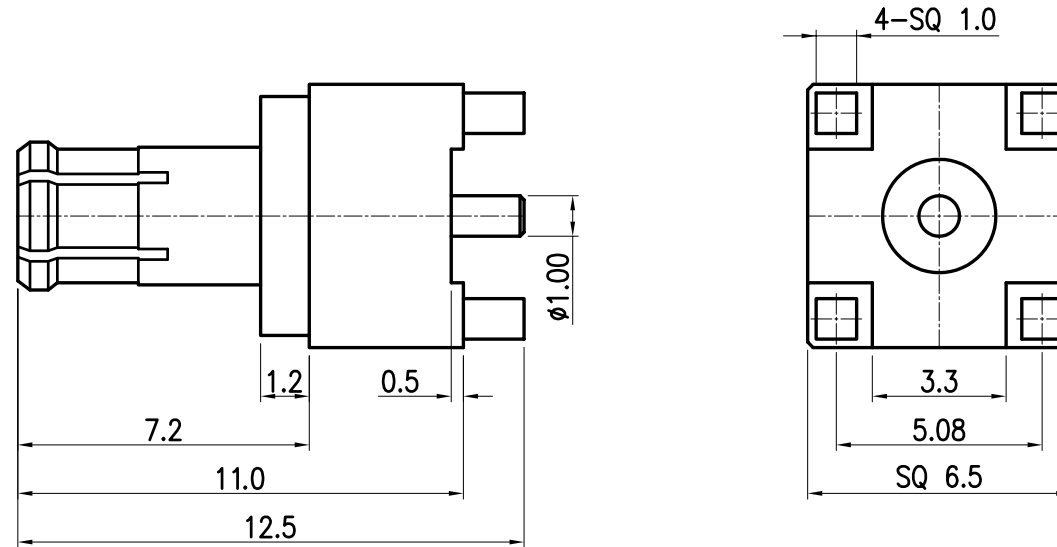

NOTE :

- Interface : CECC 22220
- Material and Finish
Center contact : Brass / Gold
Body : Brass / Gold
Insulator : PTFE
- Environmental data
Operating Temperature : -45 ~ 120C°
2002/95/EC (RoHS) : Compliant

UNLESS OTHERWISE SPECIFIED : ALL DIMS IN MILLIMETERS TOLERANCES ON DECIMALS 1 PLACE ±0.20 ANGLE ±1.0° 1.6a 2 PLACE ±0.10 REMOVE BURRS. BREAK SHARP EDGES				THIRD ANGLE 		 MICROWAVE PASSIVE DEVICE	
DRAW	DESIGN	CHECK	APPRO.	TITLE			
<i>JM_PARK</i>	<i>WY_CHO</i>		<i>CU_LEE</i>	MCX PLUG PCB RECEPTACLE			
2006.12.12	2006.12.12		2006.12.12	SIZE		DWG NO.	
Material			SEE NOTE 2.	A4		M7019-110	
Finish			SEE NOTE 2.	REV		A	
Scale : NS				Do Not Scale Drawing		1 of 1	